

DC50

NEW



General Specifications

- Impeller Diameter : 50mm
- Impeller material: Aluminum
- Housing :Galvanized steel with black painting
- Rubber parts: Silicone
- Bearing: Ball Bearing
- Lead Wire: UL1007 AWG#24 or Equivalent (+)Red, (-)Black
- Expected life: Ball Bearing 50,000hrs(40°C)
- Operating temperature -10°C~+70°C(Non-condensing)
- Storage temperature -40°C~+70°C(Non-condensing)

Dimensions(Unit:mm/inch)

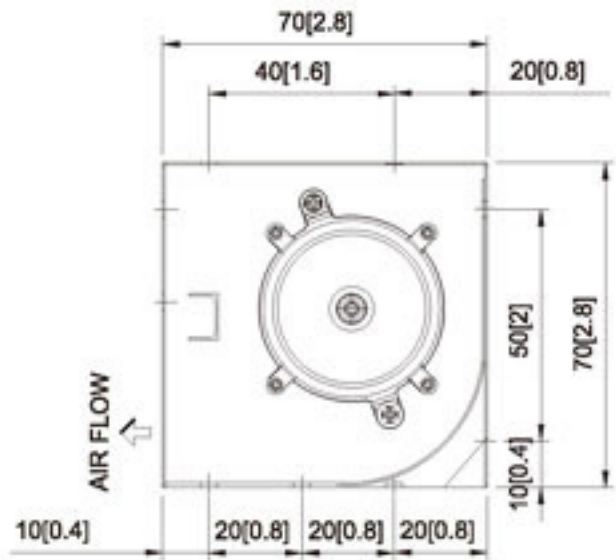
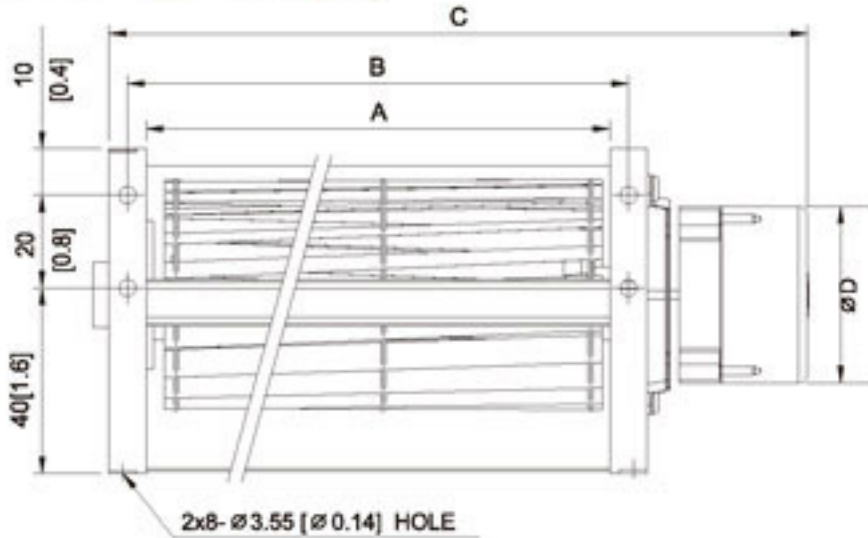

Specifications

MODEL NO.	DIMENSION(mm)			WEIGHT (g)	RATED VOLTAGE (V)	RATED CURRENT (A)	INPUT POWER (W)	SPEED (RPM)	MAX. AIR PRESSURE		MAX. AIR FLOW		NOISE dB(A)
	A	B	C						inchH ₂ O	mmH ₂ O	CFM	m ³ /min	
DC50090B12H	98	108	144	330	12	0.28	3.36	2800	0.17	4.3	32	0.9	36
DC50090B24H	98	108	144	330	24	0.16	3.84	2800	0.17	4.3	32	0.9	36
DC50150B12H	158	168	206	410	12	0.40	4.80	2500	0.16	4.0	63	1.8	37
DC50150B24H	158	168	206	410	24	0.24	5.76	2500	0.16	4.0	63	1.8	37
DC50190B12H	198	208	252	510	12	0.60	7.20	2400	0.14	3.6	88	2.5	42
DC50190B24H	198	208	252	510	24	0.35	8.40	2400	0.14	3.6	88	2.5	42
DC50250B12H	250	260	314	600	12	0.65	7.80	2400	0.14	3.6	101	2.9	43
DC50250B24H	250	260	314	600	24	0.37	8.88	2400	0.14	3.6	101	2.9	43
DC50290B12H	298	308	352	700	12	0.75	9.00	2200	0.12	3.1	124	3.5	37
DC50290B24H	298	308	352	700	24	0.40	9.60	2200	0.12	3.1	124	3.5	37
DC50350B12H	358	368	414	770	12	0.90	10.80	2300	0.13	3.3	131	3.7	48
DC50350B24H	358	368	414	770	24	0.50	12.00	2300	0.13	3.3	131	3.7	48
DC50420B12H	420	430	488	830	12	1.10	13.20	2000	0.10	2.6	145	4.1	46
DC50420B24H	420	430	488	830	24	0.60	14.40	2000	0.10	2.6	145	4.1	46

PQ Curve(At Rated Voltage)

